

# DAI STEFFL GALLERY

## COLOR KEY

TYPICAL ART WALLS

LIMITED USE

UNAVAILABLE FOR INSTALL

● OUTLET

- 1.\* 5'
2. 5'
3. 9' 3"
4. 7' 10"
5. 5'
6. 5'
7. 2'
8. 5'
9. 5'
10. 4'

\* ALL BUT WALL 1 ARE BRICK WALLS

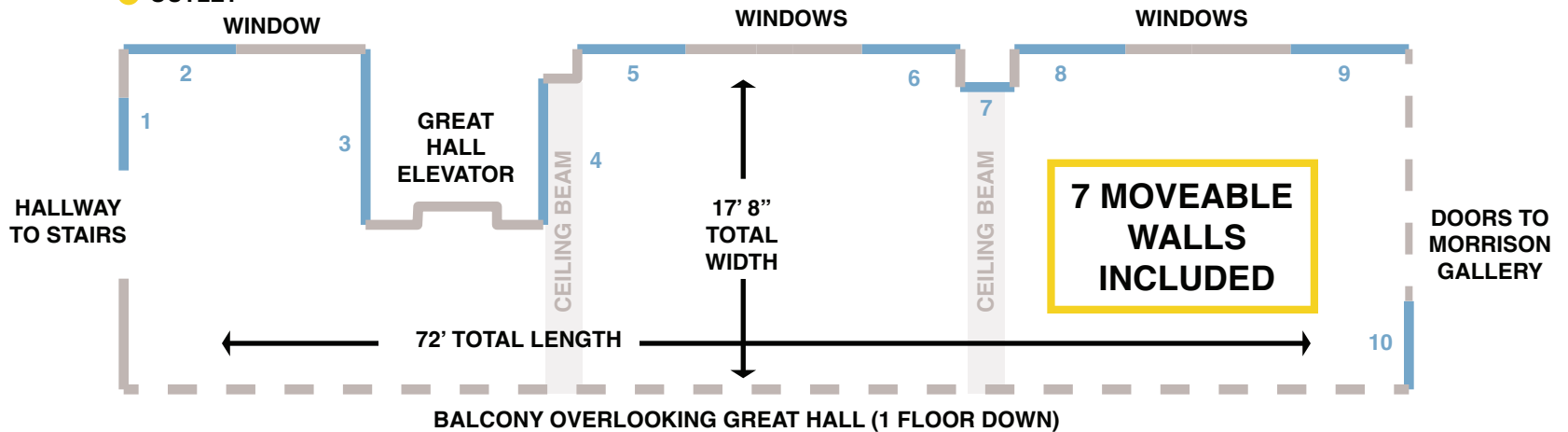

## MOVEABLE WALLS

CAN BE POSITIONED ANYWHERE, BUT CANNOT BE REMOVED FROM STEFFL

- 1 WALL: 12' x 8' x 2'  
with slanted 4' end & short 8' wall
- 5 WALLS: 8' x 8' x 2'
- 1 WALL: 6' x 4' x 2'

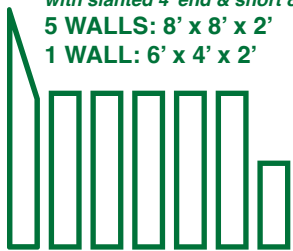

PAINT: SHERWIN WILLIAMS  
WARM STONE (SATIN)

- TRACK LIGHTING RUNS LENGTHWISE
- VAULTED CEILING EXTENDS 2 STORIES ABOVE GALLERY FLOOR
- ELECTRIC OUTLETS NOT AVAILABLE ON WALLS 1, 11, AND BALCONY
- CEILING BEAMS ARE WOODEN, SQUARE, APPROX 3' WIDE, CAN HANG WORK
- ACCESSIBLE BY ELEVATOR: DOOR 42" x 7'; INTERIOR 53" x 77" (ART MUST FIT)
- CARPETED FLOOR
- STANDARD PAINT COLOR: CUSTOM CREAM

# DAI MORRISON GALLERY

## COLOR KEY

TYPICAL ART WALLS

LIMITED USE

UNAVAILABLE FOR INSTALL

● OUTLET

1.	13' 2"
2.	15' 3"
3.	4' 10"
4.	6' 10"
5.	9' 7"
6.	14' 11"
7.	16' 7"
8.	22' 2"
9.	8'
10.	14' 7"
11.	2' 11"
12.	4' 5"
13.	12'
14.	4' 5"
15.	9' 2"
16.	4' 4"

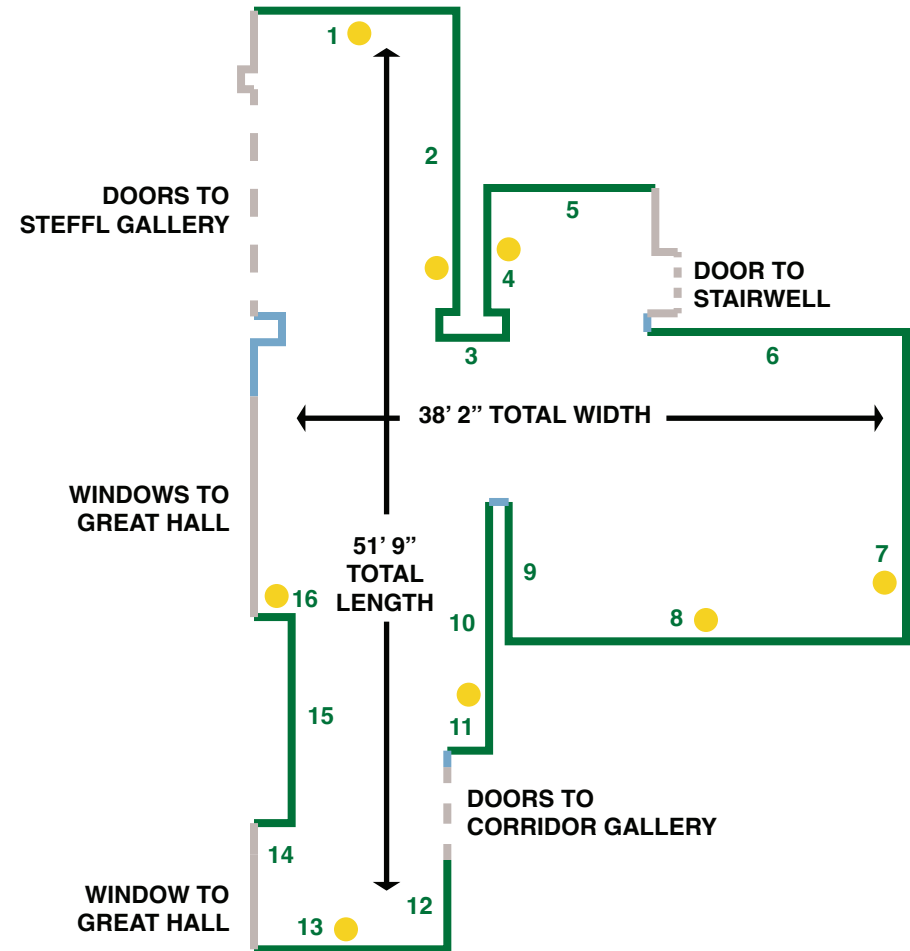

- CEILING: 15.5" WOOD BEAMS RUN LENGTHWISE EVERY 3.5'
- CEILING IN ALCOVE ABOVE WALLS 12, 13, 14 IS 9'
- VAULTED CEILING IN STAIRWELL (WALLS 4 & 5) BEGINS AT 9' 8" ON WALL 5, EXTENDS TO 12' 5"
- ACCESSIBLE BY 2 ELEVATORS ( ART MUST FIT IN LARGER ELEVATOR: DOOR 42" x 7"; INTERIOR 53" x 77")
- CARPETED FLOOR WITH RECESSED FLOOR SKIRTING
- STANDARD PAINT COLOR: CUSTOM CREAM

# DAI CORRIDOR GALLERY

- CEILING TILES WITH FLORESCENT LIGHTS
- DRYWALL WALLS WITH PENCIL SKIRTING
- CARPETED FLOORS
- ACCESSIBLE BY ELEVATOR: DOOR 35" x 7'; INTERIOR 54" x 65"
- STANDARD PAINT COLOR: SW 7005 PURE WHITE

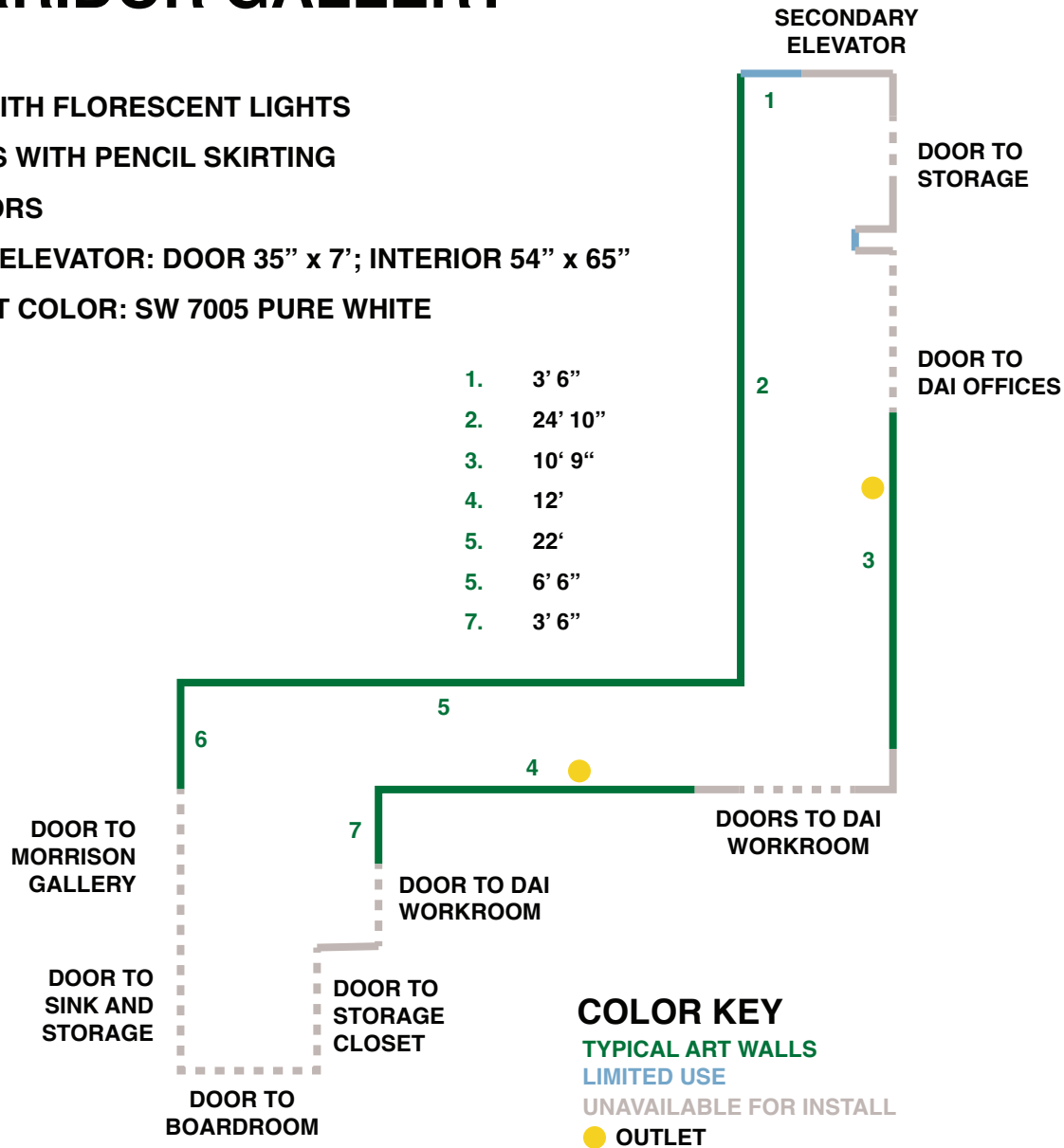

# DULUTH ART INSTITUTE GALLERIES

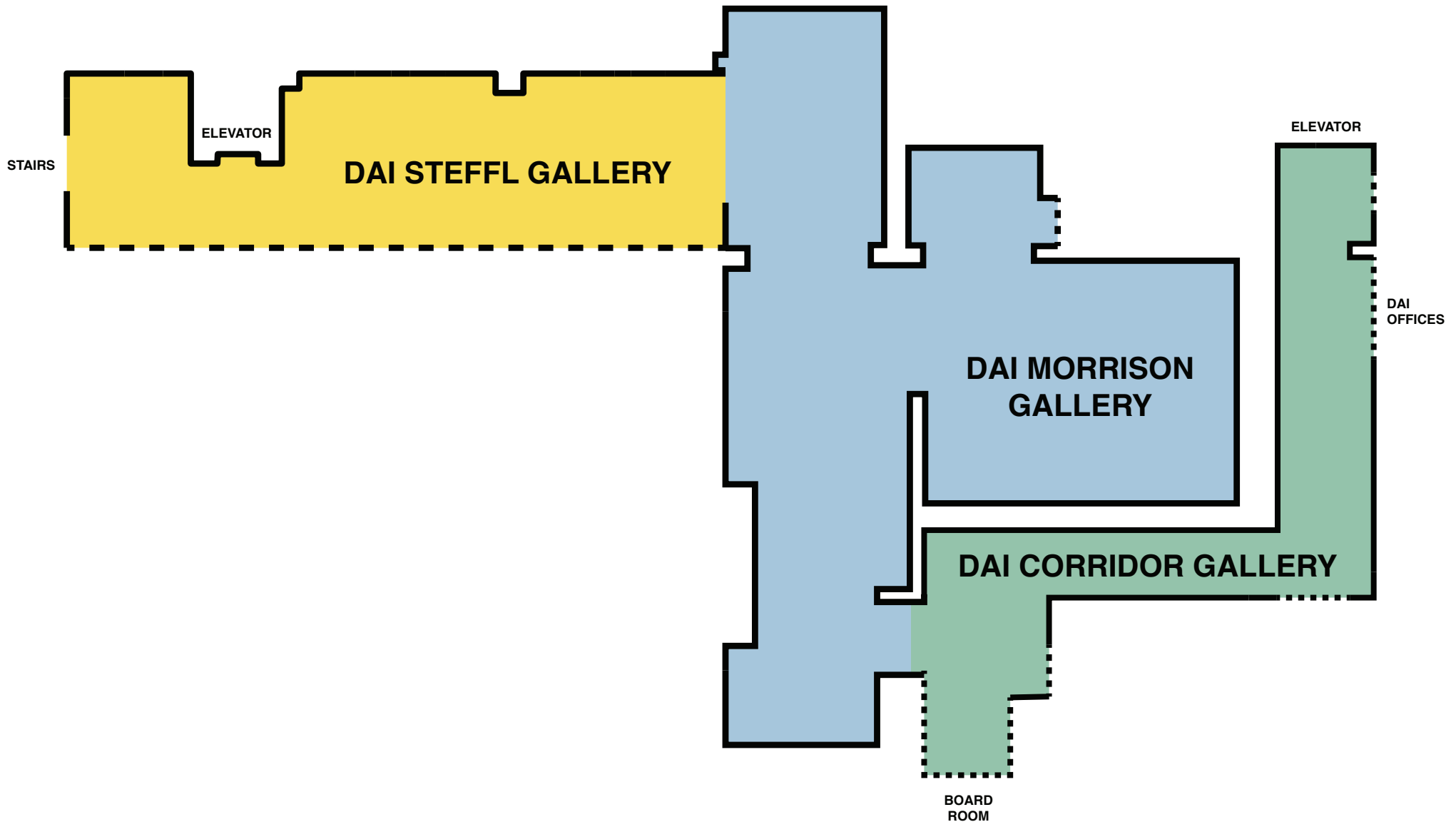

ST. LOUIS COUNTY DEPOT, 4th FLOOR